

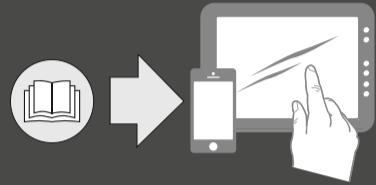

# ACA 3

- Quick Guide
- Kurzanleitung
- Guide de démarrage rapide
- Guida rapida
- Instrucciones resumidas
- Instruções resumidas
- Beknopte gebruiksaanwijzing
- Krótka instrukcja obsługi
- Snabbguide
- Kort vejledning
- Pikaohje
- Γρήγορος οδηγός
- Kisa Kilavuz
- Краткая инструкция
- 快速指南
- 快速使用指南
- クイックガイド
- 퀵 가이드

SENNHEISER



Sennheiser Documentation App



ANDROID APP ON Google play

Available on the App Store

or online at [www.sennheiser.com/download](http://www.sennheiser.com/download)  
ACA 3\_

Sennheiser electronic GmbH & Co. KG

Am Labor 1, 30900 Wedemark, Germany  
[www.sennheiser.com](http://www.sennheiser.com)

Printed in Germany, Publ. 10/19, 583927/A01

## ACA 3

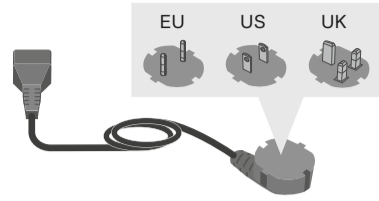

## Operating elements

### Front

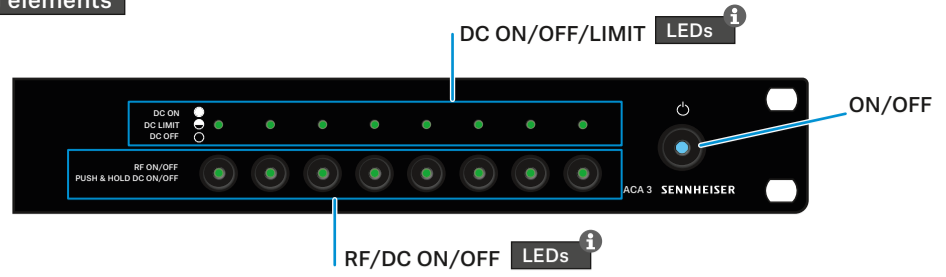

### Back

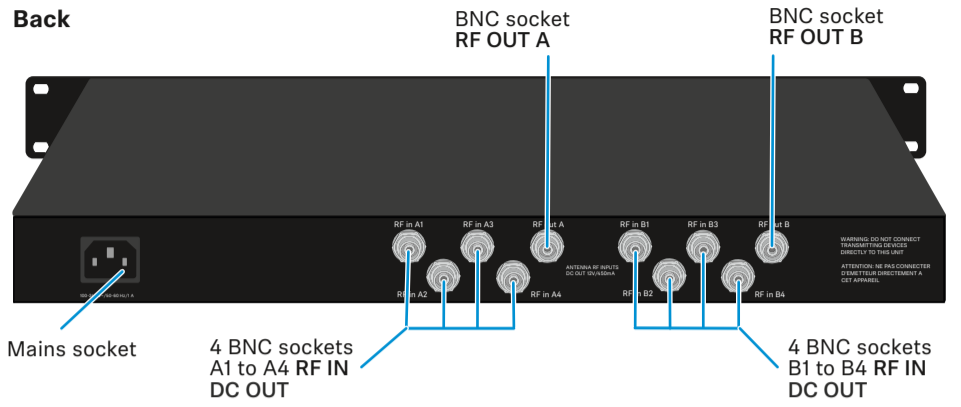

## Setup

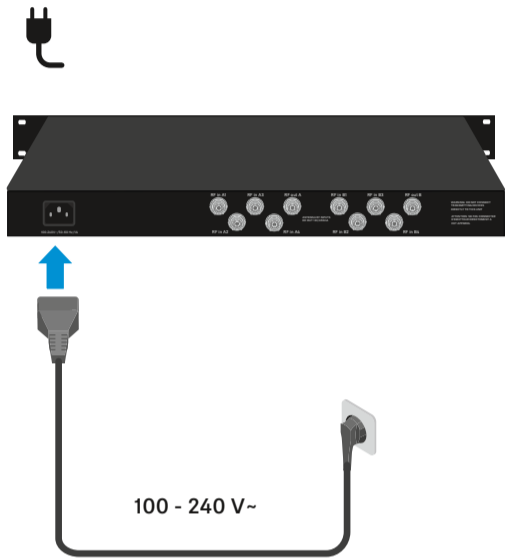

## ON/OFF

### ON/Standby

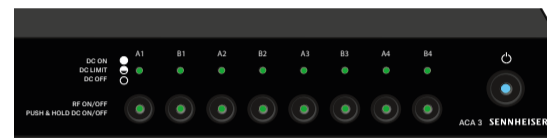

	short	long
ACA 3	on	standby
LED	on	blinking
LED RF	by memory	off
LED DC	by memory	off

### OFF

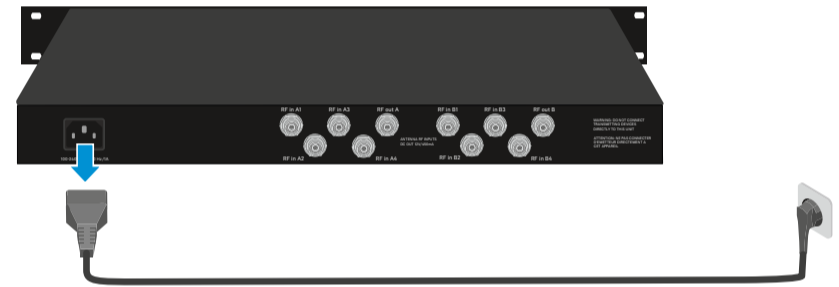

## Specifications

Frequency range	470 - 798 MHz
Gain	0 dB (±3 dB) @ 470-790 MHz
Output voltage	12 V, 250 mA max (overload protected)
Connector	BNC female, 50 Ω
Power supply	100-240 V~/ 50-60 Hz / 1A
RF input	+10 dBm max 10 mW / channel
RF output	IP3: >37 dBm (typ.); 1 dB cp: >20 dBm
Specials	Channel isolation (when switched OFF): 69 dB (typ.)
Operating relative humidity	5 to 95%
Operating temperature range	-10 °C to +40 °C
Storage temperature range	-20 °C bis +70 °C
Dimensions (incl. rack mount ears)	approx. 43 x 483 x 205 mm
Format	19 inch, 1U
Weight (incl. plug, cable)	approx. 2750 g

## Operating modes

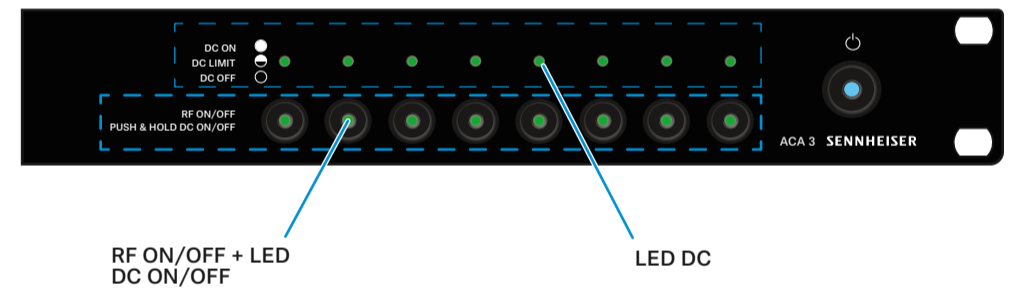

	short	long
RF	on/off	-
DC	-	on/off

LEDs	DC	RF
on	✓	✓
blinking	LIMIT	-
off	✗	✗

## Setup

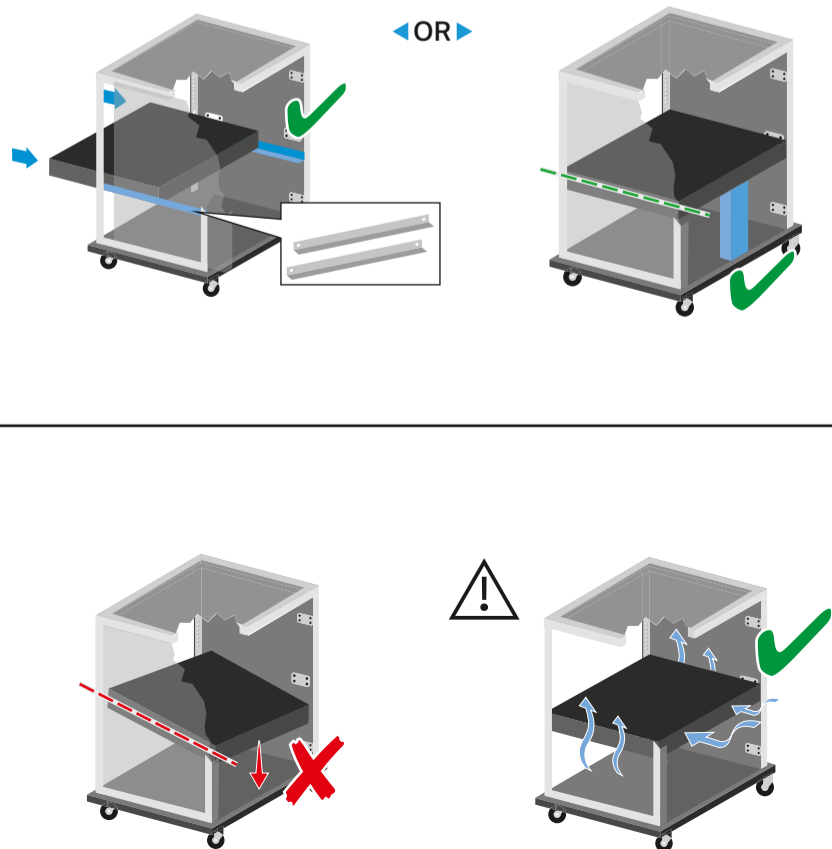

## Connecting devices

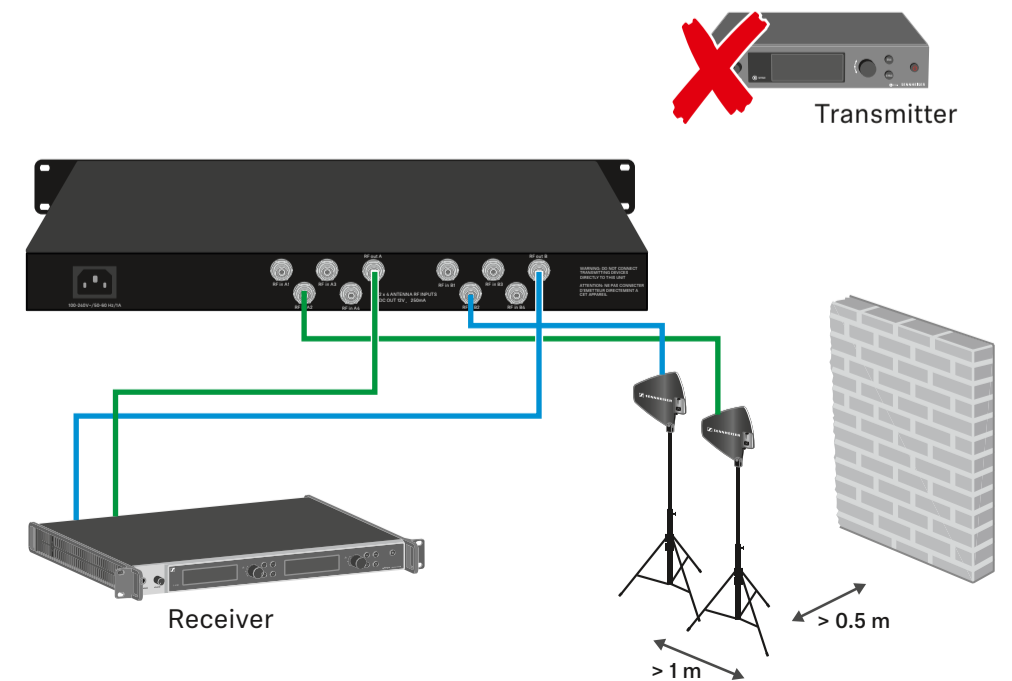

Example 1: Studio Complex

- RF IN A1 - A4
- RF IN B1 - B4

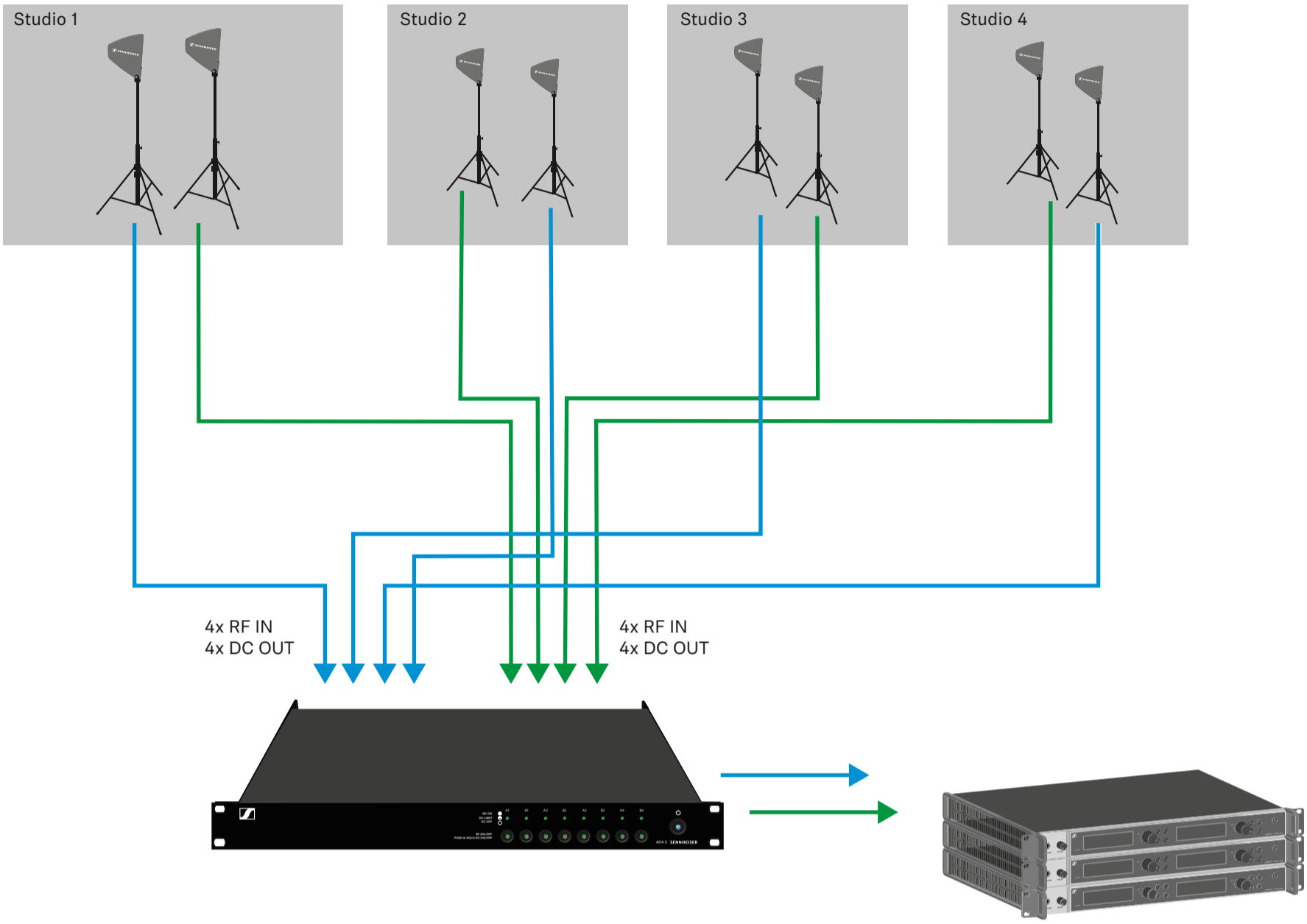

Example 2: Large Church

- RF IN A1 - A4
- RF IN B1 - B4

